

Blender

brushed stainless steel housing



Bellini®

BTBL55

Important Safeguards

When using electrical appliances, in order to reduce the risk of fire, electric shock and/or injury, these basic safety precautions should always be followed:

For Your Safety

Read all instructions carefully, even if you are familiar with the appliance.

- DO NOT IMMERSE the motor base in water or any other liquid.
- Do not allow the cord to hang over edge of a table or counter, or touch hot surfaces. Do not operate or place any part of this appliance on or near a hot gas or electric burner, or in a heated oven.
- This appliance is not intended for use by persons (including children) with reduced physical, sensory and mental capabilities, or lack of experience and knowledge, unless they have been given supervision or instruction concerning use of the appliance by a person responsible for their safety.
- Children should be supervised to ensure that they do not play with the appliance.
- Never allow a child to operate this appliance.
- Children are vulnerable in the kitchen, particularly when unsupervised and if appliances are being used or cooking is being carried out.
- Teach children to be aware of dangers in the kitchen, warn them of the dangers of reaching up to areas where they cannot see properly or should not be reaching.
- Children should be supervised to ensure they do not play with the appliance.
- Switch off the power outlet and remove the plug before cleaning or when the appliance is not in use.
- Avoid contact with moving parts. Keep hands, hair and clothing, as well as spatulas and other utensils, away during operation to prevent injury and/or damage to the appliance.
- Do not operate any appliance with a damaged cord or plug; if the appliance malfunctions; or if it is dropped or damaged in any manner.
- Do not use attachments or accessories not provided with the Blender.
- Do not use any appliance for anything other than its intended use. This product is intended for household use only.
- Do not use outdoors.
- Do not attempt to repair, disassemble or modify the appliance. There are no userserviceable parts.
- Handle sharp blender blades carefully to avoid cuts and injuries.
- Do not leave the Blender unattended when operating.
- Do not allow the cord to hang over the edge of a table or counter, or touch hot surfaces.
- Do not operate or place any part of this appliance on or near any hot surfaces (such as a gas or electric burner, or in a heated oven).
- Keep hands and utensils out of the jar while operating the appliance. A rubber scraper can be used when the Blender is turned off.
- Always operate the Blender with the cover locked into place.
- When blending hot liquids, pour them through the special insert on the lid of the jar and begin processing at a lower speed. Keep hands and other exposed skin away from the cover to prevent possible burns.
- Do not leave the Blender unattended when operating.
- Do not use the jar for storing foods or beverages.
- Do not use the appliance for mixing paints or other flammable liquids, or in a location contaminated with flammable gases or vapours.
- Do not misuse the cord. Never carry the appliance by the cord or pull to disconnect it from the outlet. Instead, grasp the plug and pull to disconnect.

Compulsory Warning

If the supply cord is damaged, the cord must be replaced by the manufacturer, its service agent or similarly qualified persons in order to avoid a hazard.

This product has not been designed for any uses other than those specified in this booklet.

Save These Instructions

Features of Your Blender

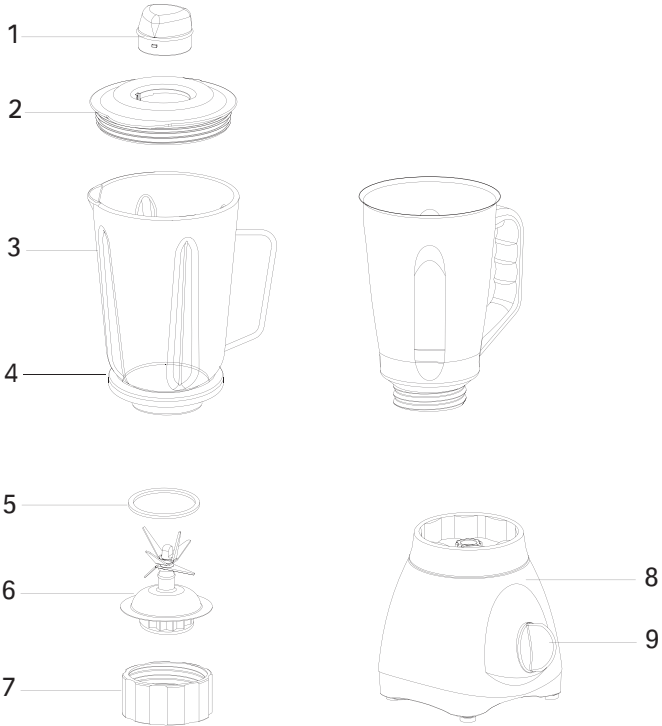

- 1) Measuring Cup
- 2) Lid
- 3) Jar
- 4) Safety Ring
- 5) Sealing Ring
- 6) Cutting Blade
- 7) Cup Base
- 8) Motor Base
- 9) Rotary Switch

Getting to Know Your Blender

Congratulations on the purchase of your new Blender.

Before using your new Blender, it is most important that you read and follow the instructions in this use & care booklet, even if you feel you are familiar with this type of appliance.

Your attention is drawn particularly to the section dealing with IMPORTANT SAFEGUARDS. Find a safe and convenient place to keep this booklet handy for future reference.

This appliance has been designed to operate from a standard domestic power outlet. It is not intended for industrial or commercial use.

Before First Use

- All parts of the blender are to be thoroughly cleaned before being used for the first time.
- Take out the required length of cable from the cable tidy on the base of the blender and connect the device to the mains supply.

Assembling the Jar

- Put the rubber sealing ring (5) on the inner edge of the blade unit (6).
- Put the blade unit with sealing ring into the cup base (7).
- Insert the assembled cup base onto the bottom of the jar and secure tightly.
- Mount the jar(3) onto the cup base unit and and turn clockwise until the jar locks in place.

Secure the Lid onto the Jar and press down.

Note: the safety ring (4) is fixed on the jug (3), do not try remove it.

Inserting the Jar

- Make sure that the blender is switched off (Switch to the '0' setting).
- Place the jar assembly (3) on to the motor base (8) and press down until securely engaged.

How to Use Your Blender

- Place the ingredients you wish to process into the jar.
- Put the lid on the jar and close securely. Place the measuring cap into the hole in the lid and turn clockwise to lock.
- Operate the motor for a maximum of 1 minute or alternate 1 minute on, then 3 minute off to prevent overheating or consequent damage.
- Switch on the motor base:

Speed setting	Use
1	for light usage with liquids
2-5	more solid consistency – for mixing liquids and solid foods
0	stop operation
P	for ice crushing & short, powerful impulse movements

(The switch does not permanently engage in the 'PULSE' setting. You have to hold the switch in the 'PULSE' setting or turn it repeatedly into the 'P' setting).

After using the blender, always move the switch into the '0' setting and pull out the mains plug. To remove the glass jar simply lift it off the motor base. You do not have to rotate the glass jar to remove it.

Useful Tips

- To achieve the best results when pureeing solid ingredients, place small portions into the glass jar one by one instead of placing a large quantity all at once.
- If you are processing solid ingredients, cut them into small pieces (2-3cm) first.
- When mixing solid ingredients start off first with a small amount of liquid. Gradually add more and more liquid through the opening in the lid.
- Always place your hand on top of the blender when you are operating the device.
- For stirring solid or very thick liquid ingredients we recommend that you use the blender in impulse mode to prevent the blades from becoming stuck.

Care & Cleaning

- Never immerse the motor base in water. Wipe it only with a moist cloth.
- Empty the glass jar and fill it with water. Place the glass jar on the motor base and turn the switch several times into the 'P' setting.
- Empty the glass jar and rinse until clean.

Notes

Warranty

The benefits conferred by this warranty are in addition to all implied warranties, other rights and remedies in respect of the product which the consumer has under the Trade Practices Act and similar State and Territory Laws.

The original purchaser of this Bellini product is provided with the following warranty, subject to the following conditions.

This product is warranted for a period of 1 year from the date of purchase for all parts defective in workmanship or materials. Should an instance occur where the product is deemed faulty, the product will need to be returned to the retailer where it was purchased to be replaced with the same product or product of equivalent value and type free of charge, or a refund issued. In order to obtain an exchange or a refund, proof of purchase must be presented to the retailer.

This warranty is in addition to all other rights and remedies available under the Trades Practices Act 1974 and other relevant State and Territory laws and shall not be taken as applying to exclude, restrict or modify such rights or remedies in any other matter whatsoever.

WARRANTY CONDITIONS

1. This warranty is only valid for appliances used according to the manufacturer's instructions.
2. This appliance must not be modified or changed in any way.
3. Connection must be to the voltage requirements as specified in the ratings label located on the product.
4. The manufacturer does not accept liability for any direct or consequential damage, loss or other expense arising from misuse or incorrect installation and operation of the appliance.

5. Warranty will only be given where proof of purchase is provided, e.g. original invoice.
6. Not designed or warranted for industrial or commercial use.

DO NOT SEND IN THIS WARRANTY

Fill out the following details and file with your purchase invoice.

RETAIN & FILE WITH YOUR RECEIPT

Your Purchase Receipt/Invoice is proof of date of purchase. You must be able to present it at the place of purchase to obtain a replacement or a refund.

GSM International Ltd reserves the right to discontinue items, modify designs and change specifications without incurring obligation. Whilst every effort is made to ensure that descriptions, specifications and other information in this publication is correct, no warranty is given in respect thereof and the company shall not be liable for any errors therein.

Purchased from: _____

Co. Name: _____

Address: _____

Date of Purchase: _____

NOTE: Consistent with our continuing product development policy, improvements may have been made which render the contents of this package slightly different to that shown.

Cat. No. BTBL55
January 2011

G | S | M

Gerard Sourcing & Manufacturing

GSM International Ltd.

GSM International Ltd has a policy of continual improvement throughout the product range. As such the unit contained within may differ slightly from the unit illustrated on the pack.

MADE IN CHINA for GSM International Ltd.



N1028