

Bellini

INSTALLATION & OPERATION INSTRUCTIONS



60cm Freestanding Dishwasher

Model No.

BDW127W

BDW127W-F Fineline 5102930 Aus/NZ

BDW127S

BDW127S-F Fineline 5102932 Aus Only

BDW127X

BDW127X-F Fineline 5102931 Aus/NZ

'We recommend you open the door slightly 50mm to assist in the drying of the dishes after every wash as the drying of the dishes is a natural process'

V.7 SEPT19

Thank you

Thank you for choosing Bellini Appliances.

Bellini prides itself on 'affordable living' making sure there is no compromise in your favourite room ... The Kitchen

All Bellini appliances carry a 3 year In Home warranty, be sure to retain your installation and user manual and receipt.

For all warranty and technical queries please contact

1300 373 199

Content

Safety instructions-----	2
Product description-----	4
Installation-----	6
Start using your appliance-----	8
Maintenance and cleaning-----	17
Troubleshooting-----	19
Warranty-----	22

Important Safety Instructions

This manual explains the proper installation and use of your the appliance, please read it carefully before using even if you are familiar with the product. The manual should be kept in a safe place for future reference. In case of failure, only the Authorised Technical Service may repair this dishwasher. Otherwise the guarantee will be null and void. All Bellini Appliances are for domestic use only.

General Warnings

- ◆ Under certain conditions, Hydrogen gas may be produced in a hot-water system that has not been used for two weeks or more. HYDROGEN GAS IS EXPLOSIVE. If the hot-water system has not been used for such a period, before using the dishwasher turn on all hot-water faucets and let the water flow from each for several minutes. This will release any accumulated hydrogen gas. As the gas is flammable, do not smoke or use an open flame during this time.
- ◆ If the supply cord is damaged, the cord must be replaced by the manufacturer, its service agent or similarly qualified persons in order to avoid a hazard.
- ◆ This product has not been designed for any uses other than those specified in this booklet.
- ◆ Do not use the appliance in the event of a technical fault. Any faults must be fixed by an appropriately qualified and authorised person.
- ◆ In the event of any incident caused by a technical fault, disconnect the power and report the fault to the service centre to be repaired.
- ◆ The rules and provisions contained in this instruction manual should be strictly observed.
- ◆ Do not allow anybody who is not familiar with the contents of this instruction manual to operate the appliance.
- ◆ Do not abuse, sit on, or stand on the door or dish basket of the dishwasher.
- ◆ Do not touch the heating element during or immediately after use.
- ◆ Do not place any heavy objects or stand on the door when it is open. The appliance could tip forward.

Child Safety

- ◆ This appliance is not intended for use by persons (including children) with reduced physical, sensory or mental capabilities, or lack of experience and knowledge, unless they've been given supervision or instruction concerning use of the appliance by a person responsible for their safety.
- ◆ Children should be supervised to ensure that they do not play with the appliance.
- ◆ Avoid contact with skin and eyes, and keep children away from the dishwasher when the door is open.
- ◆ Dishwasher detergent is corrosive! Take care to keep it out of reach of children.
- ◆ Accessible parts will also become hot when in use. To avoid burns and scalds children should be kept away.

Installation, Cleaning & Servicing

- ◆ The appliance must be installed only by an authorised person in compliance with the instructions provided. Incorrect installation may cause harm to persons, animals or may damage property.
- ◆ Before using the appliance, ensure that all packing materials are removed from the appliance.
- ◆ The unit's power cord must be connected to a properly grounded and protected, 220-240V electrical outlet. Always use ground fault protection where required by the electrical code.
- ◆ When transporting or storing the unit, keep it in a dry location, free from dust, excessive vibration or other factors, which may damage the unit.
- ◆ Do not operate the appliance with a damaged cord, plug or if the appliance has malfunctioned or has been dropped or damaged in any manner. Return the appliance to authorised service facility for repair.

- ◆ Only authorised personnel should carry out servicing. (Certificate of Compliance to be retained)
- ◆ Always ensure the appliance is switched off before cleaning or replacing parts.
- ◆ **THIS APPLIANCE MUST BE EARTHED.**
- ◆ To maintain safe operation, it is recommended that the product be inspected every five years by an authorised service person.
- ◆ During installation, the power supply must not be excessively or dangerously bent or flattened.
- ◆ Do not tamper with controls.
- ◆ The appliance is to be connected to the water mains using new hose sets, and the old hose-sets should not be reused.
- ◆ Never use a spray cleaner to clean the door panel, it could damage the door lock and electrical components.
- ◆ Do not use the abrasive agent or some paper towel because of the risk of scratching or leaving spots on the stainless steel surface.

The appliance

- ◆ Do not operate your dishwasher unless all enclosure panels are properly in place. Open the door very carefully if the dishwasher is operating. There is a risk of water squirting out.
- ◆ When loading items to be washed:
 - Locate sharp items so that they are not likely to damage the door seal;
 - Load sharp knives with the handles up to reduce the risk of cut-type injuries;
- ◆ Warning: Knives and other utensils with sharp points must be loaded in the basket with their points down or placed in a horizontal position.
- ◆ When using your dishwasher, you should prevent plastic items from contacting with heating element.
- ◆ Check that the detergent receptacle is empty after completion of the wash cycle.
- ◆ Do not wash plastic items unless they are marked dishwasher safe or the equivalent. For plastic items not so marked, check the manufacturer's recommendations.
- ◆ Use only detergent and rinse additives designed

for an automatic dishwasher. Never use soap, laundry detergent, or hand washing detergent in your dishwasher.

- ◆ Other means for disconnection from the supply must be incorporated in the fixed wiring with at least 3mm contact separation in all poles.
- ◆ Dishwasher detergents are strongly alkaline. They can be extremely dangerous if swallowed.
- ◆ The door should not be left in the open position since this could present a tripping hazard.
- ◆ To avoid an accident, ensure that the appliance shelves and fittings are always inserted into the appliance in accordance with the instructions.
- ◆ Do not use the door as a shelf.
- ◆ Do not push down when the appliance door is open.
- ◆ Indoor use only.

Environmental Hints

- ◆ Packaging material could be dangerous for children!
- ◆ For disposing of package and the appliance please go to a recycling centre. Cut off the power supply cable and make the door closing device unusable.
- ◆ Cardboard packaging is manufactured from recycled paper and should be disposed in the waste paper collection for recycling.
- ◆ By ensuring this product is disposed of correctly, you will help prevent potential negative consequences for the environment and human health, which could otherwise be caused by inappropriate waste handling of this product.
- ◆ For more detailed information about recycling of this product, please contact your local city office
- ◆ and your household waste disposal service
- ◆ This product must not be disposed together with domestic waste. This product has to be disposed at an authorised place for recycling of electrical and electronic appliances.
- ◆ By collecting and recycling waste, you help save natural resources, and make sure the product is disposed in an environmental friendly and healthy way.



Product Description



- 1 Upper Basket
- 2 Spray Arms
- 3 Lower Basket
- 4 Filters
- 5 Detergent Dispenser
- 6 Rinse Aid Dispenser
- 7 Cutlery Tray
- 8 Cup Holder

W x D x H (mm)	600x600x850
Power Socket	12A, 240V a.c 50Hz
Power Supply	240V a.c 50Hz
Water Pressure:	0.04--1.0MPa
Capacity:	12 Places
Hot Water Connection:	Max 60°C

Filter System(Item 4 Above)

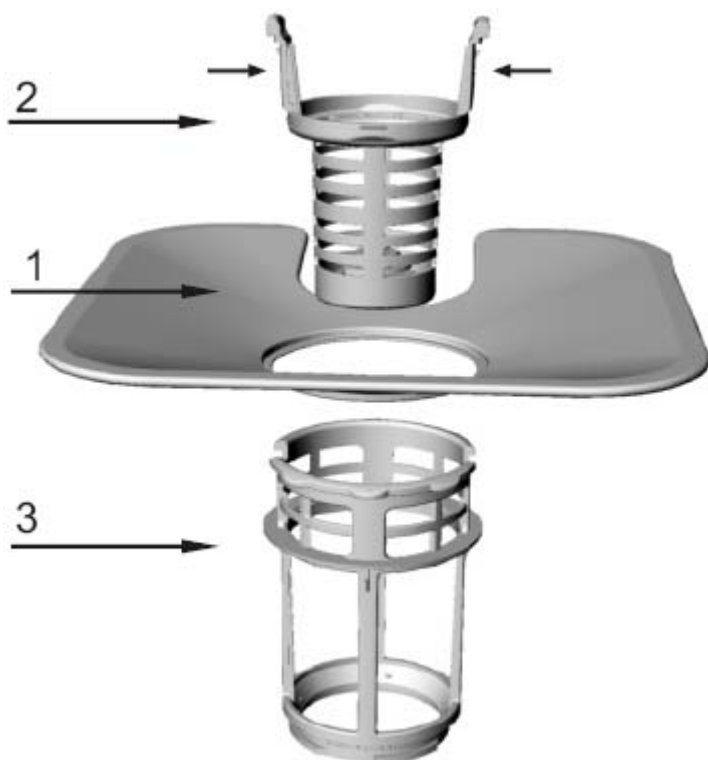

The filter system consists of a coarse filter, a flat(main filter) and a micro filter (fine filter).

1. Flat Filter

Food and debris will be trapped by a special jet on the lower spray arm.

2. Coarse Filter

Large debris, such as bone and glass that could clog the drain will be trapped in the coarse filter.

To remove an item caught in this filter, gently squeeze the taps on the top of this filter and lift it out.

3. Micro Filter

This filter holds soil and food residue in the sump area and prevents it from being redeposited on the dishes during a cycle.

Dispenser(Item 5&6 Above)

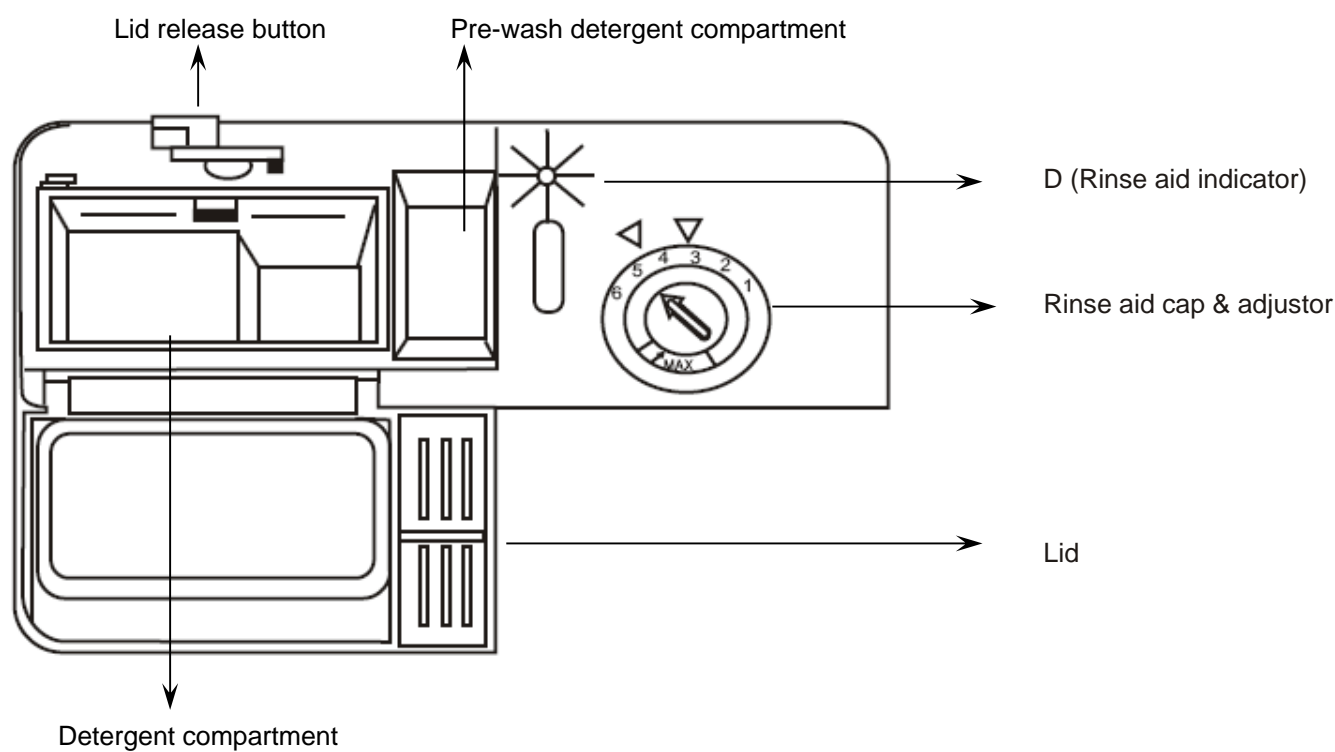

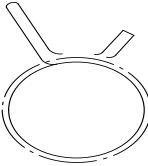
Accessory Name	Picture	Quantity
User Manual		1
Drain hose hanger		1
Hose Hook		1

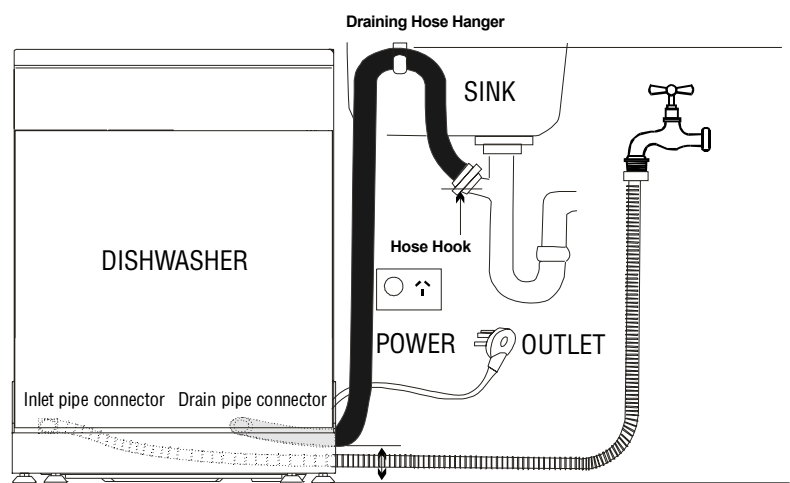

Installation



Warning



Electrical Shock Hazard!

Disconnect electrical power before installing dishwasher.

Failure to do so can result in death or electrical shock.

Positioning & Leveling

1. Take out the appliance from all packaging and check to ensure no damaged during transportation. If it has been damaged, contact the retailer and do not proceed and further with the installation process.
2. Check the dishwasher by placing it so that its sides or back panel are in contact with the adjacent cabinets or wall. It can also be recessed under a single work top.
3. Place the dishwasher on a level and sturdy floor. If the floor is uneven, the front feet of the appliance may be adjusted until it reaches a horizontal position (the lean angle must not exceed 2 degrees). The maximum adjustable height of feet is 20mm. Proper placing horizontally can significantly reduce vibrations or noise while it is running.

Connection Of Water And Electricity

Warning!

- ◆ Connection to the water and electricity supplies should only be performed by a qualified technician.
- ◆ The dishwasher should not stand on top of the water hoses or the electricity supply cable
- ◆ The appliance must be connected to the water supply network using new piping. Do not use old piping.

Connection Of Water Inlet Hose

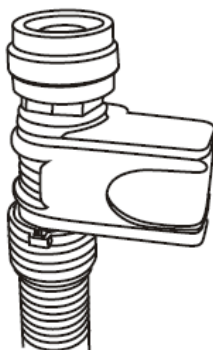
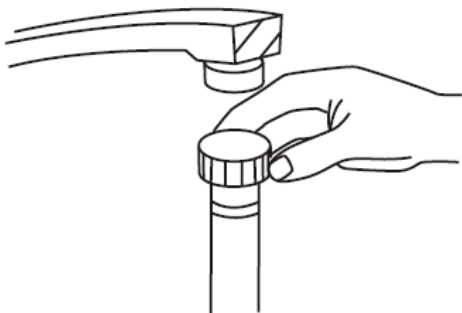

Connect the cold water supply hose to a threaded 3/4(inch)connector and make sure that it is fastened tightly in place. If the water pipes are new or have not been used for an extended period of time, let the water run to make sure the water is clear and free of impurities. If this precaution not taken, there is a risk that the water inlet can get blocked and the appliance could be damaged.

Ensure that the water inlet hose is not kinked or squashed.

Connection Of Water Outlet Hose

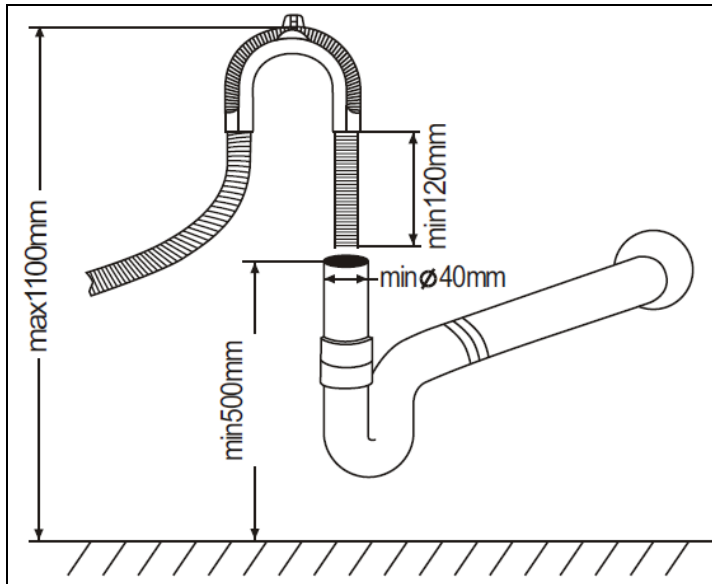

Fit the drainage hose of your machine to the drainage pipe without bending.

If the length of the hose is not sufficient, apply to the authorized service for an extension made from the same material as the original.

Remember that the length of the hose should not exceed 4 meters even when with an extension.

If the drainage hose is longer than 4 m. the dishes will not be cleaned properly secure your hose firmly to the drainage pipe to avoid it coming off during the washing process.

Connection Of Electricity

Attention!

Before inserting the plug into the electrical socket, make sure that:

- The socket is earthed and complies with current regulations.
- The socket can withstand the maximum load of the appliance, which is indicated on the data plate located on the inside of the door.
- The power supply voltage falls within the values indicated on the data plate on the inside of the door;
- The socket is compatible with the plug of the appliance. If this is not the case, ask an authorized technician to replace the plug
- Do not use extension cables or multiple sockets.

Warning!

- ◆ Once the appliance has been installed, the power supply cable and the electrical socket should be easily accessible.
- ◆ The cable should not be bent or compressed.
- ◆ If the power supply cable is damaged, it must be replaced by the manufacturer or its Technical Assistance Service in order to prevent all potential hazards.
- ◆ The company shall not be held responsible for any incidents that occur if these regulations are not observed.

How to Drain Excess Water From Hoses

If the sink is 1000mm higher from the floor, the excess water in hoses cannot be drained directly into the sink. It will be necessary to drain excess water from hoses into a bowl or a suitable container that is held outside and lower than the sink.

Syphon Connection

The waste connection must be at a height of between 50cm (minimum) and 100cm (maximum) from the bottom of the dish. The water drain hose should be fixed by a hose clip.

Start Using Your Appliance

1. Before using

1.1 Fill the Rinse Aid Dispenser

Attention!

Only use branded rinse aid for dishwasher. Never fill the rinse aid dispenser with any other substances (e.g. dishwasher cleaning agent, liquid detergent). This could damage the appliance. Rinse aid is automatically added during the last rinse, ensuring thorough rinsing, spot and streak free drying.

When to fill

You can judge the amount of rinse aid by the colour of the optical level indicator "D" located next to the cap. When the rinse aid container is full, the whole indicator will be dark. As the rinse aid diminishes, the size of the dark dot decreases. You should never let the rinse aid get below 1 / 4 full.

As the rinse aid diminishes, the size of the black dot on the rinse aid level indicator changes, as illustrated below.

- Full (About 140ml)
- ◐ 3 / 4 full
- ◑ 1 / 2 full
- ◒ 1 / 4 full - Should refill to eliminate spotting
- Empty
- D (Rinse aid indicator)

How to fill

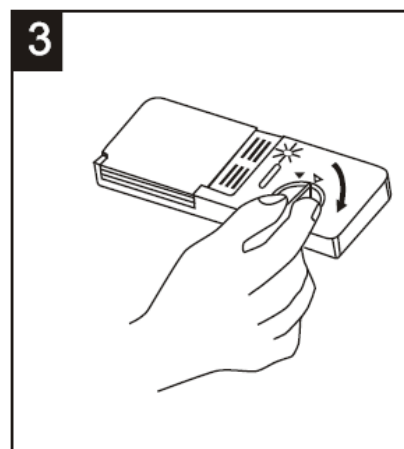
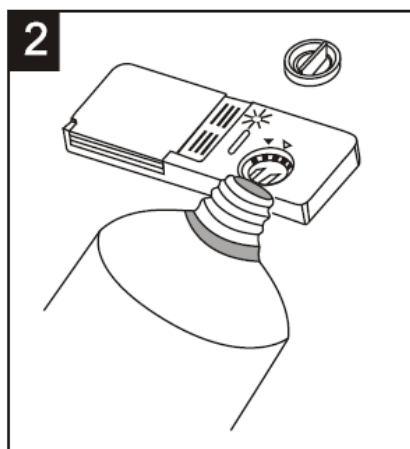
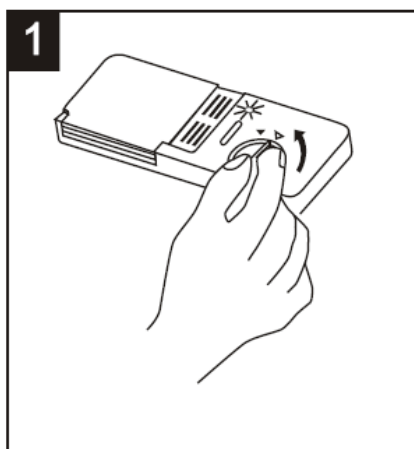

1. Open the dispenser, turn the cap to the "open" (left) arrow and lift it out.
2. Pour the rinse aid into the dispenser until indicator turn to "full", be careful not to overfill.
3. Replace the cap by inserting it aligned with "open" arrow and turning it to the "closed" (right) arrow.

The rinse aid is released during the final rinse to prevent water from forming droplets on your dishes that can leave spots and streaks. It also improves drying by allowing water to sheet off the dishes.

Your dishwasher is designed to use liquid rinse aids. The rinse aid dispenser is located inside the door next to the detergent dispenser.

Attention!

- ◆ Clean up any rinse aid spilt during filling with an absorbent cloth to avoid excess foaming during the next wash.
- ◆ Do not overfill the dispenser, because this could cause over sudsing. Wipe away any spills with a damp cloth. Don't forget to replace the cap before you close dishwasher door.

Adjusting Rinse Aid Dispenser

The rinse aid dispenser cap has 6 settings. Always start from "4" but if dish spots and streaks serious please set it to "5" or higher to increase the amount of rinse aid. Factory default set is "5".

NOTE: Increase the dose if there are water drops or spots on the dishes after washing. Decrease if there is sticky & whitish stains on the dishes, or bluish stains on glassware and knife blades.

1.2 Fill The Detergent

- ◆ Detergents with its chemical ingredients are necessary to remove dirt, crush dirt and move it out of the dishwasher. Most of commercial quality detergents are suitable for this purpose. Based on their chemical composition, dishwasher can be split in two basic types:
 - conventional, alkaline detergents with caustic components
 - low alkaline concentrated detergents with natural enzymes
- ◆ The use of "normal" washing program in conjunction with concentrated detergents reduces pollution and is good for your dishes; these washing programs are specially matched to the dirt-dissolving properties of the enzymes of the concentrated detergent. For this reason "normal" washing program in which concentrated detergents are used can achieve the same results that can otherwise only be achieved using "intensive" program.
- ◆ Detergent tablets of different brands dissolve at different speeds. For this reason some detergent cannot dissolve and develop their full cleaning power during short program. Therefore please use long program when using detergent tablets, to ensure the complete removal of detergent residuals.
- ◆ There are 3 sorts of detergents
 - With phosphate and with chlorine
 - With phosphate and without chlorine
 - Without phosphate and without chloride

How to fill

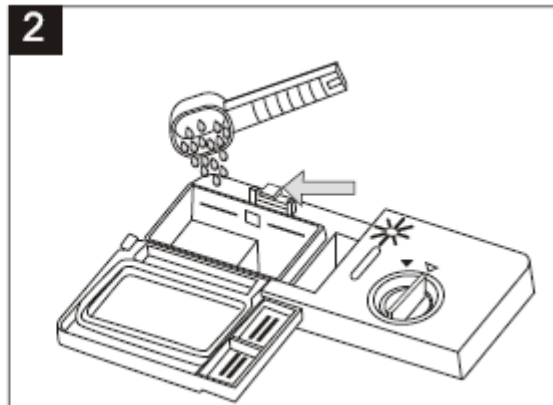
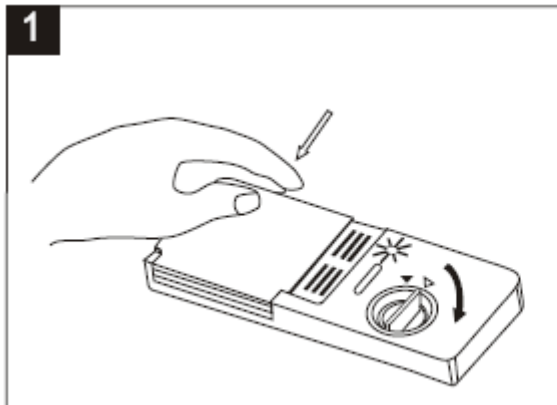

1. Press the lid release button to open the lid.
2. Fill detergent into detergent compartment or pre-wash compartment (MIN. of detergent compartment means about 20g and for pre-wash is about 5g).
3. Close the lid until it locked.

Attention!

- ◆ If the dishes are heavily soiled, place an additional detergent dose in the pre-wash detergent compartment. This detergent will take effect during the pre-wash phase.
- ◆ The dispenser must be refilled before the start of each washing cycle following the instructions provided in the Wash Cycle Table. Your dishwasher uses less detergent and rinse aid than conventional dishwashers. Generally, only one tablespoon of detergent is needed for a normal wash load. Also, more heavily soiled items need more detergent. Always add the detergent just before starting dishwasher, otherwise it could get damp and will not dissolve properly.
- ◆ Only use branded detergent aid for dishwasher.
- ◆ Keep your detergent fresh and dry.
- ◆ Don't put powder detergent into the dispenser until you're ready to wash dishes.

2. Load Dishwasher Baskets

Attention!

- ◆ Scrape off any large amounts of leftover food. It is not necessary to rinse the dishes under running water. Place objects in the dishwasher in the following way:
 - Items such as cups, glasses, pots/pans, etc. are placed upside down.
 - Curve items, or those with recesses, should be at a slant so that water can run off.
 - They are stacked securely and can not tip over.
 - They do not prevent the spray arms from rotating while washing takes place.
- ◆ Very small items should not be washed in the dishwasher as they could easily fall out of the Baskets.
- ◆ The upper and lower baskets can not be pulled out in the same time when the dishwasher is Loading, or it may lead to dumping.
- ◆ To prevent water dripping from the upper basket into the lower basket, we recommend that you empty the lower basket first and then the upper basket.

2.1 Loading The Upper Basket

Upper Basket

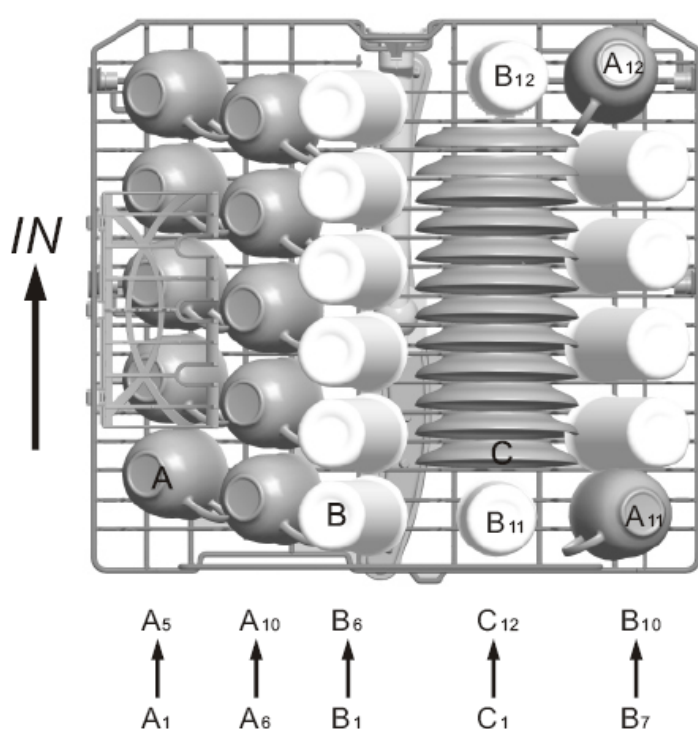

Type	Item
A	Cup
B	Glass
C	Saucer

The upper basket is designed to hold more delicate and lighter dishware such as glasses, coffee, tea cup/saucers, as well as plates, small bowls or shallow pans (as long as they are not too dirty). Position the dishes and cookware so that they do not get moved by the spray of water.

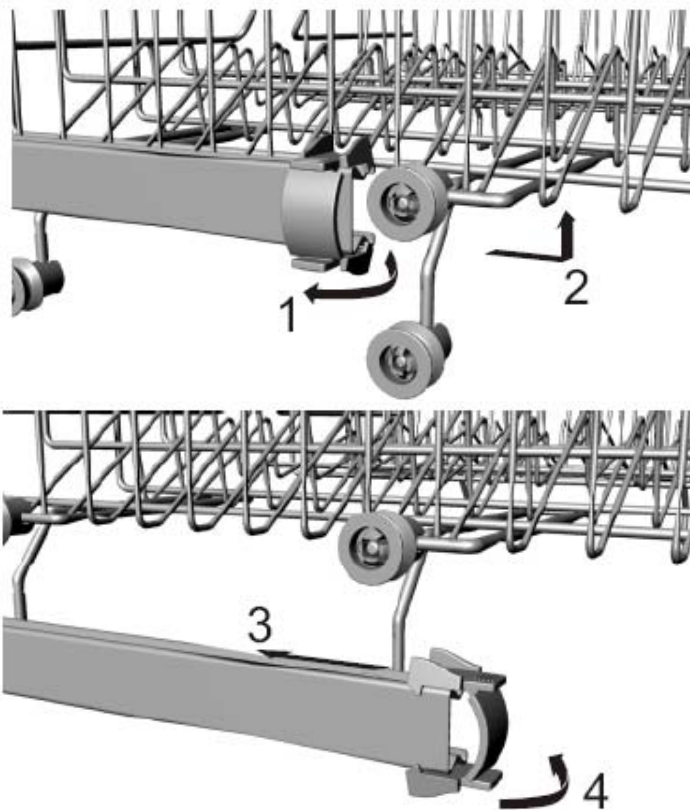

If needed, height of the upper basket can be adjusted to create more space for large utensils either in the upper basket or lower basket. The upper basket can be adjusted for height by putting wheels of different height into the rails. Long items, serving cutlery, salad servers or knives should be placed on the shelf so that they do not obstruct the rotation of the spray arms. The shelf can be folded back or removed when not be required for use.

2.2 Loading The Lower Basket

Lower Basket

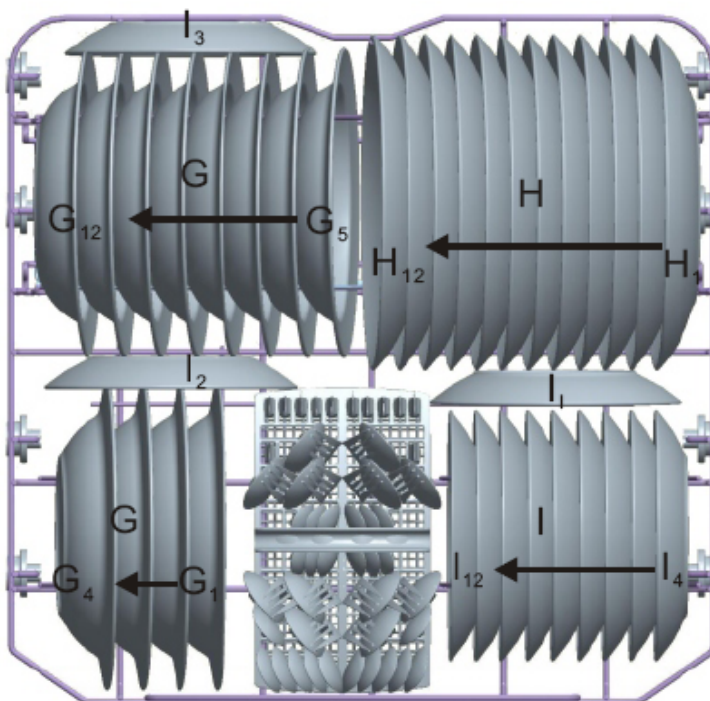

Type	Item
G	Soup plate
H	Dinner plate
I	Dessert plate

We recommend that you place large items which are most difficult to clean into the lower basket like pots, pans, lids, serving dishes or bowls. It is preferable to place serving dishes and lids on the side of the baskets in order to avoid blocking the rotation of the top spray arm. Pots, serving bowls, etc. must always be placed top down. Deep pots should be slanted to allow water to flow out. Fold the tine sections down towards each other if you need space for pots or other large items. Fold down the right-hand section only and lean cups against the upright tines for extra stability.

2.3 Folding Racks (Optional only)

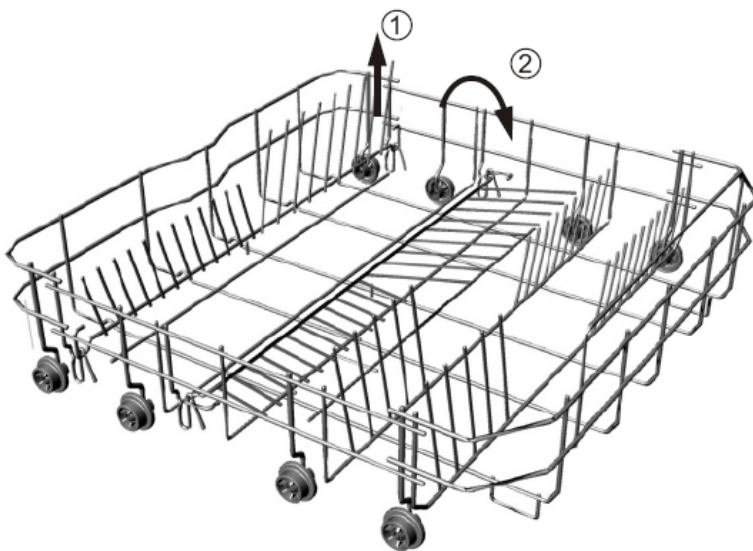

Folding racks consisting of two parts that are located on the lower basket which are designed to allow you place big items easier as pots, pans, etc. If needed, each part can be folded separately, or all of them can be folded for larger space. You can use folding racks by raising them upwards, or by folding.

2.4 Cutlery Tray

Cutlery should be placed in the cutlery tray with handles at the bottom. If the tray has side baskets, the spoon should be loaded individually into the appropriate slots, especially long utensils should be placed in the horizontal position at the front of the upper basket.



Type	Item	
1	Teaspoons	
2	Dessert Spoons	
3	Soup Spoons	
4	Forks	
5	Knives	

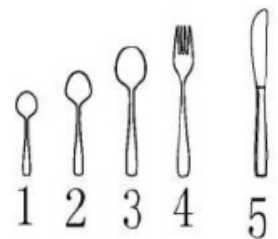

Door side

Attention!

- ◆ For washing in the dishwasher the following cutlery/dishes







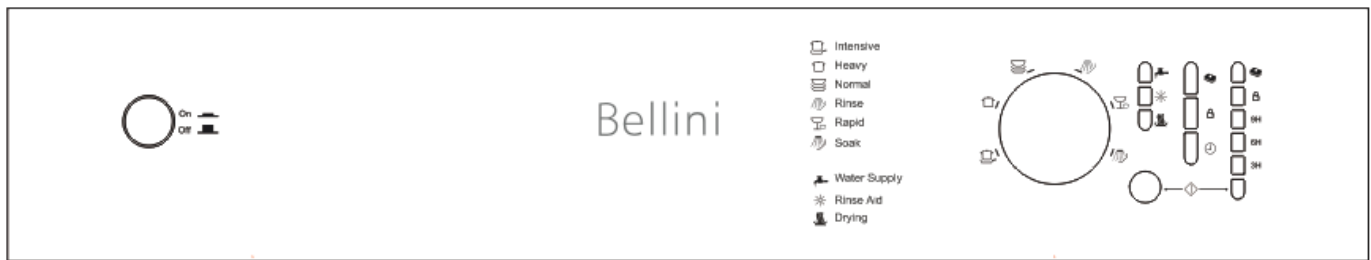

Are NOT suitable	Are limited suitable
<ul style="list-style-type: none">● Cutlery with wooden, horn china or mother-of-pearl handles● Plastic items which are not heat resistant● Older cutlery with glued parts that are not heat resistant● Bonded cutlery items or dishes● Pewter or copper items● Lead crystal glass● Steel items subject to rusting● Wooden platters● Items made from synthetic fibre	<ul style="list-style-type: none">● Certain types of glasses can become dull after a large number of washes● Silver and aluminum parts have a tendency to discolour during washing● Glazed patterns may fade if washed frequently

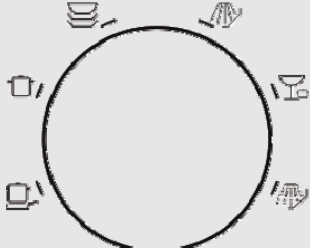



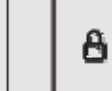

- ◆ Do not let any item extend through bottom
- ◆ Do not put in items that are dirty of cigarette ash, candle wax, lacquer or paint.
- ◆ If you buy new dishes please make sure that they are suitable for dishwashers. Do not use dish that is not suitable for dishwashers. This is important for good results and for reasonable energy consumption.
- ◆ Do not overload your dishwasher. There is only space for 12 standard dishes.
- ◆ Before loading the dishes, you should remove large left-over and soften remnants of burnt food in pans
- ◆ Dishes and cutlery must not impede the rotation of the spray arms.
- ◆ Load hollow items such as cups, glasses, pans etc. with the opening downwards so that water won't stay in the container or a deep base.
- ◆ Dishes and items of cutlery must not lie inside one another, cover or touch with each other to avoid damage or lower washing performance
- ◆ Long bladed knives stored in an upright position are a potential hazard!
- ◆ Long and/or sharp items of cutlery such as carving knives must be positioned horizontally in the upper basket

3. Start Washing

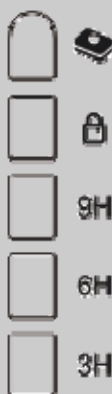



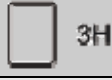

3.1 Control Panel



	ON/OFF	To turn on/off the power supply.	
	Program Selector	Rotate to choose desired program. See clause 3.2 for details.	
	Warning Indicator Lights		Flash if water is not supplied properly for example the tap turn off, water supply interrupted or supply hose kinked.
			Turn ON when rinse aid needs to be refilled.
			Turn ON when the dishwasher is in the drying process.
	Operation Buttons		<p>“All in one” tablet. Your dishwasher can use “All in one” powder for easier cleaning. This kind of powder already had rinse aid and detergent mixed in, so no need you to fill them separately into corresponding compartment.</p> <p>Press this button until “All in one” indicator light flashing to choose this function. Then press “Start/Pause” button to start “All in one” washing cycle.</p>
			<p>Child lock. Depress and hold this button for 3s, child lock will be activated and all buttons will be locked. Child lock indicator light will turn ON. Depress again for 3s to unlock.</p>
			<p>Delay start time. Press this button, delay start time will be circularly loop as 3 hours – 6 hours – 9 hours – cancel. Corresponding indicator light will turn ON.</p>

	Function Indicator Lights		“All in one” indictor light. Flashing when door closed and “All in one” function is chosen. Stay as ON when “All in one” washing cycle is running.	
			Turn ON when Child lock is activated.	
			Turn ON when 9 hours delay time is chosen.	
			Turn ON when 6 hours delay time is chosen.	
			Turn ON when 3 hours delay time is chosen.	
	Start\Pause Button	You can start or pause the expected washing cycle and additional function when by pressing the button.		
	Status Indicator Light	Stay as ON with high brightness		Washing cycle running
		Flash with high brightness		Dishwasher paused
		Flash with low brightness		End of washing program

3.2 Washing Programs

Program	Cycle Selection	Description of Cycle	Detergent Pre/main	Running Time (min)	Energy (kWh)	Water (L)
 Intensive	For the heaviest soiled loads, such as pots, pans, casserole dishes and dishes that have been sitting with dried food for a while.	Pre-wash (40°C) Main wash (55°C) Rinse Hot rinse (65°C) Drying	5/25g (or “All in one”)	145	1.20	15.5
 Heavy	For heavy soiled loads, such as pots, plates, glasses and lightly soiled pans.	Main wash (60°C) Rinse Rinse Hot rinse (65°C) Drying	5/25g (or “All in one”)	135	1.15	15.0
 Normal*	For normal soiled loads, like pots, plates, glasses and lightly soiled pans.	Main wash (45°C) Rinse Hot rinse (49°C) Drying	5/25g (or “All in one”)	112	0.73	11.8
 Rinse	For dishes that need to be rinsed and dried only	Pre-wash Hot rinse(70°C) Drying		67	0.75	7.5
 Rapid	A shorter wash for lightly soiled loads that do not need drying.	Main wash (40°C) Hot rinse (49°C)	15g	50	0.50	7.5
 Soak	To rinse dishes that you plan to wash later that day	Pre-wash		8	0.01	4.0

Attention!

- ◆ Normal program: this programme is the test cycle. accordance with AS/NZS.2007.1, as follows:
 - Capacity: 12 settings
 - Position of Upper basket: upper wheels on rails
 - Rinse aid setting: 5(or 4 for four setting dispenser)
- ◆ We recommend you open the door slightly 50mm to assist in drying of the dishes after every wash.

3.3 Start Washing

- A. Load basket and fill in detergent according to section 1 & 2.
- B. Make sure that the water supply is turned on to full pressure.
- C. Open the door, press the ON/OFF button,
- D. Press the "program" button to select desired washing program
- E. Close the door until a click is heard which will mean the door has closed correctly.

3.4 Caution

- It is dangerous to open the door when washing has commenced as the hot water may scald you.
- If you want to open the door during washing without turning off the appliance to add dishes, open the door a little, wait for the spray arms to stop working, open the door completely and add dishes.
- It is best to do this before detergent has released. If detergent has already been released, you will need to re-fill the detergent dispenser.
- If a wash program is running and you open the door, the dishwasher will pause and the warning alarm will ring and E1 will display. Program will continue 10 seconds after you have closed the door.
- If you want to change a wash program that has been selected, you must turn off the dishwasher and re-select the desired wash program.

3.5 Wash Cycle Complete

Warning!

Open the door carefully. Hot steam may escape when the door is opened!

- A. Pressing the ON/OFF button to switch off the appliance, the Status indicator light flash with low brightness.
- B. Open the door carefully as the hot steam will escape when the door is opened!
- C. Let dishes cool down for 15 minutes before unloading from the dishwasher. This way, dishes will be cooler and the drying performance will be improved.
- D. Unload the dishwasher
- E. Empty the lower basket first, then the upper basket.

Maintenance and Cleaning

Remove the Plug

Before cleaning or performing maintenance, always remove the plug from the socket.

No Solvents or Abrasive Cleaning

To clean the exterior and rubber parts of the dishwasher, do not use solvents or abrasive cleaning products. Use only a cloth and warm soapy water. To remove spots or stains from the surface of the interior, use a cloth dampened with water and a little white vinegar, or a cleaning product made specifically for dishwashers.

When You go on holiday

It is recommended that you run a wash cycle with the dishwasher empty and then remove the plug from the socket, turn off the water supply and leave the door of the appliance slightly ajar. This will help the seals last longer and prevent odors from forming in the appliance.

Moving the Appliance

If the appliance must be moved, try to keep it in the vertical position. If absolutely necessary, it can be positioned on its back.

Seals

One of the factors that cause odors to form in the dishwasher is food that remains trapped in the seals. Periodic cleaning with a damp sponge will prevent this.

Cleaning The Door

A soft warm, damp cloth is suggested. To prevent penetration of water into the door lock and electrical components, do not use a spray cleaner. Also, never use abrasive cleaners or scouring pads on the outer surfaces because they will scratch the finish. Some papers towels can also scratch or leave marks on the surface.

Caring for the Dishwasher

To clean the control panel, use a lightly dampened cloth then dry thoroughly.

To clean the exterior, use a good appliance polish wax. Never use sharp objects, scouring pads or harsh cleaners on any part of the dishwasher.

Cleaning The Spray Arms

It is necessary to clean the spray arms regularly for hard water chemicals will clog the spray arm jets and bearings. To remove the spray arms, screw off the nut clockwise to take out the washer on top of the spray arm and remove the arm. Wash the arms in soapy and warm water and use a soft brush to clean the jets. Replace them after rinsing thoroughly.

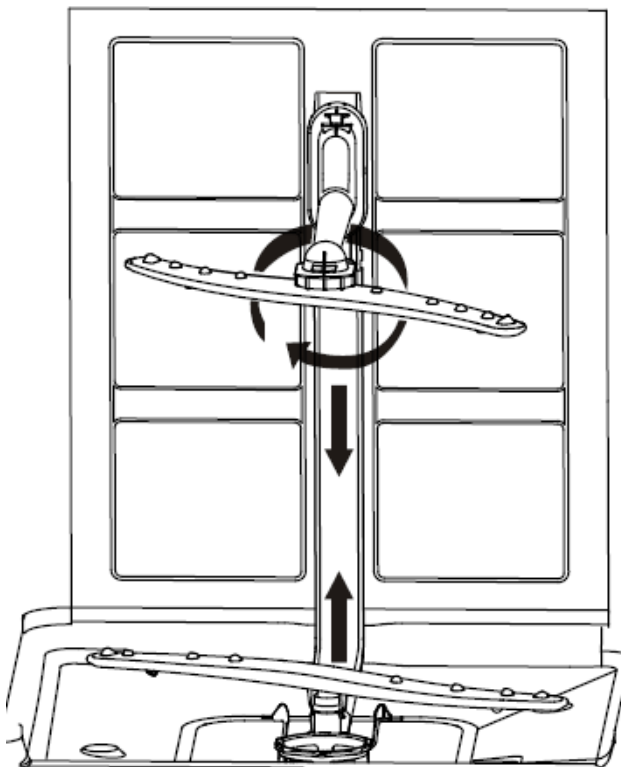

Protect Against Freezing

1. If your dishwasher is left in an unheated place during the winter, ask a service technical to:
2. Cut off electrical power to the dishwasher.
3. Turn off the water supply and disconnect the water inlet pipe from the water valve.
4. Drain water from the inlet pipe and water valve. (Use a pan to catch the water)
5. Reconnect the water inlet pipe to the water valve.
6. Remove the filter in the tub and the bottom and use a sponge to use up water in sump

Clean filter assembly

The filter is used to avoid the big remnants and other sundries getting inside the pump, efficiently removes food particles from the wash water, allow recirculation during the cycle. The residue can obstruct the filter sometime so suggest removing the larger food particles trapped in the filter after each wash cycle by rinsing the semicircular filter and cup under running water.

For best performance and results, suggest clean the filter assembly every week.

To remove the filter assembly, pull on the cup handle in the upward direction.

To clean the coarse and the micro filter, use a cleaning brush.

Contrarotate to unscrew the coarse filter, you can remove the filter system. Remove any food remnants and clean the filters under running water.(Refer to page 2 “product description” to understand more about filter system)

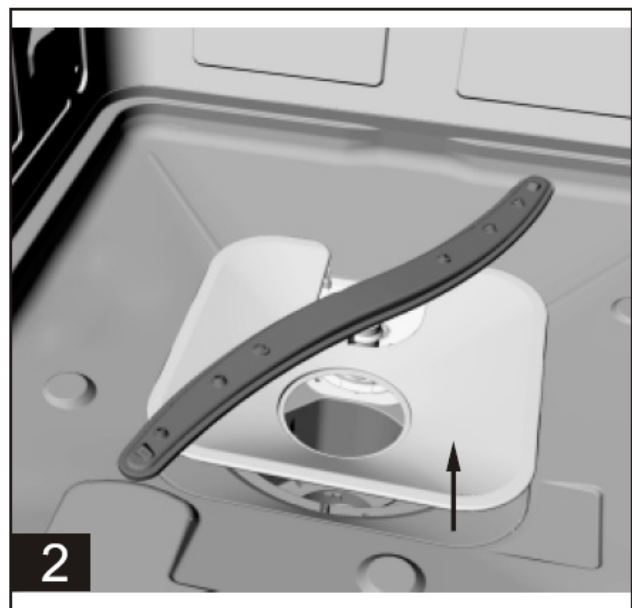
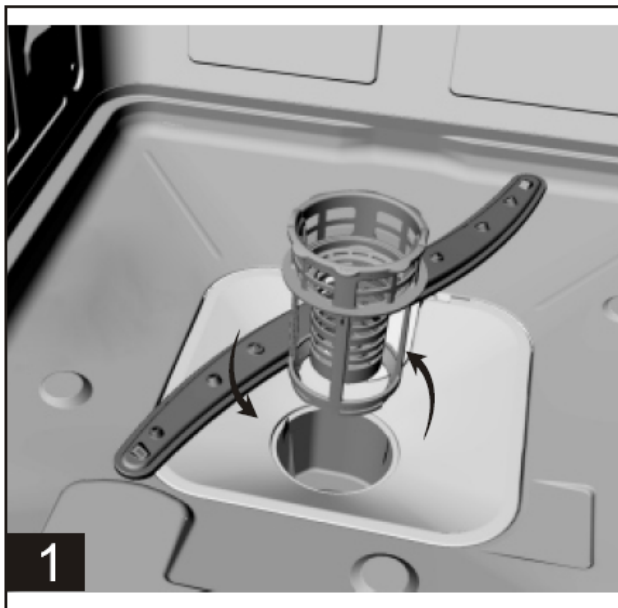

Then, reassemble the filter parts as shown in the figures below and reinsert the entire assembly in the dishwasher, positioning in its seat and pressing downward.

Attention!

- ◆ The dishwasher must never be used without the filters. Improper replacement of the filter may reduce the performance level of the appliance and damage dishes and utensils.
- ◆ Never run the dishwasher without the filters in place. When cleaning the filters, don't knock on them. Otherwise, the filters could be contorted and the performance of dishwasher could be debased.

Troubleshooting

Error code

When some malfunctions happen, the appliance will have below actions to warn you.

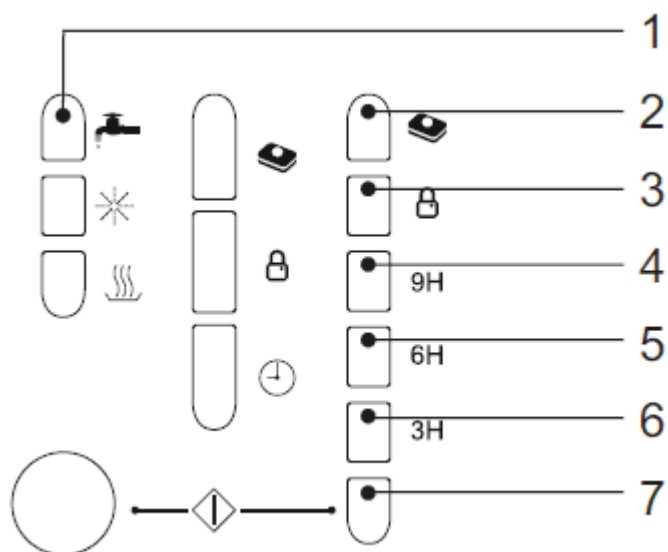

When Below Indicator Flash	Meanings	Possible Causes
2 & 4	Door open	The door is opened when the dishwasher is operating
1	Water inlet	Water inlet malfunction
2 & 5	Water drainage	Water drainage malfunction
2 & 6	Temperature sensor	Temperature sensor malfunction
2 & 7	Overflow/leakage	Overflow occurs/Water leakage occurs
3 & 4	Water leakage	Water leakage occurs
3 & 5	Heating element	Abnormal heating

Warning!

If overflow occurs, turn off the main water supply before calling a service. If there is water in the base pan because of an overfill or small leak, the water should be removed before restarting the dishwasher.

Troubleshooting

Problem	Possible Causes	What To Do
Dishwasher doesn't run	Fuse blown, or the circuit breaker acted	Replace fuse or reset circuit breaker. Remove any other appliances sharing the same circuit with the dishwasher.
	Power supply is not turned on	Make sure the dishwasher is turned on and the door is closed securely. Make sure the power cord is properly plugged into the wall socket.
	Water pressure is low	Check that the water supply is connected properly and the water is turned on.
Drain pump doesn't stop	Overflow	The system is designed to detect an overflow. When it does, it shuts off the circulation pump and turns on the drain pump.
Noise	Some audible sounds are normal	Sound from detergent cup opening.
	Utensils are not secure in the baskets or something small has dropped into the basket	To ensure everything is secured in the dishwasher.
	Motor hums	Dishwasher has not been used regularly. If you do not use it often, remember to set it to fill and pump out every week, which will help keep the seal moist.
Suds in the tub	Improper detergent	Use only the special dishwasher detergent to avoid suds. If this occurs, open the dishwasher and let suds evaporate. Add 1 gallon of cold water to the tub. Close and latch the dishwasher, then start the "soak" wash cycle to drain out the water... Repeat if necessary.
	Spilled rinse agent	Always wipe up rinse agent spills immediately.
Stained tub interior	Detergent with colorant was used	Make sure that the detergent is the one without colorant.
Dishes and flatware not clean	Improper program Improper basket loading	Make sure that the action of the detergent dispenser and spray arms are not blocked by large dishware. Select a stronger programme.
Spots and filming on glasses and flatware	<ul style="list-style-type: none"> Extremely hard water Low inlet temperature Overloading the dishwasher Improper loading Old or damp powder detergent Empty rinse agent dispenser Incorrect dosage of detergent 	<p>To remove spots from glassware:</p> <ol style="list-style-type: none"> Take out all metal utensils out of the dishwasher. Do not add detergent. Choose the longest cycle. Start the dishwasher and allow it to run for about 18 to 22 minutes, then it will be in the main wash. Open the door to pour 2 cups of white vinegar into the bottom of the dishwasher. Close the door and let the dishwasher complete the cycle. If the vinegar does not work: Repeat as above, except use 1/4 cup (60 ml) of citric acid crystals instead of vinegar.
Cloudiness on glassware	Combination of soft water and too much detergent	Use less detergent if you have soft water and select a shortest cycle to wash the glassware and to get them clean.

Yellow or brown film on inner surfaces	Tea or coffee stains	Using a solution of 1/2 cup of bleach and 3 cups of warm water to remove the stains by hand. WARNING! You have to wait for 20 minutes after a cycle to let the heating elements cool down before cleaning interior; otherwise, burns will happen.
	Iron deposits in water can cause an overall film	You have to call a water softener company for a special filter.
White film on inner surface	Hard water minerals	To clean the interior, use a damp sponge with dishwasher detergent and wear rubber gloves. Never use any other cleaner than dishwasher detergent for the risk of foaming or suds.
Detergent dispenser lid can't be closed properly	Clogged detergent residue is blocking the catch	Clean the detergent from the catch.
Detergent left in dispenser cups	Dishes block detergent Cups	Re-loading the dishes correctly.
Steam	This is normal	There is some steam coming through the vent by the door latch during drying and water draining.
Black or gray marks on dishes	Aluminum utensils have rubbed against dishes	Use a mild abrasive cleaner to eliminate those marks.
Water in the bottom of the tub	This is normal	A small amount of clean water around the outlet on the tub bottom keeps the water seal lubricated.
Dishwasher leaks	Overfill dispenser or rinse aid spills	Be careful not to overfill the rinse aid dispenser. Wipe away any spills with a damp cloth.
	Dishwasher isn't placed horizontally	Make sure the dishwasher is in a horizontal position.

WARRANTY

- 1.1 In this warranty:
- 1.1.1 Australian Consumer Law means the law as set out in Schedule 2 of the Competition and Consumer Act 2010;
 - 1.1.2 **Company** means GSM Retail Australia Pty Ltd ABN 53 007 682 475 of 142-144 Fullarton Road, Rose Park SA 5067. Telephone 1300 373 199. Email admin@gsmretailaust.com.au;
 - 1.1.3 **Consumer** means a “consumer” as that term is defined in Section 3 of the Australian Consumer Law as the original purchaser of a Bellini product;
 - 1.1.4 **Consumer Guarantees** means the guarantees under the Australian Consumer Law;
 - 1.1.5 **You** means the Consumer.
- 1.2 Nothing in this warranty affects any person’s rights under the Australian Consumer Law. The benefits to any Consumer under this warranty are in addition to the rights and remedies available under any Consumer Guarantees.
- 1.3 Subject to the other clauses of this warranty, the Company warrants to the Consumer that the Bellini product will be free of manufacturing defects and will perform to the Company’s specifications.
- 1.4 The benefit of this warranty extends only to the Consumer as original purchaser of a Bellini product which is installed in a domestic household area.
- *The in Home warranty does not apply to Commercial and or industrial usage. *Please See 1.7.7 for additional information*
- 1.5 This warranty commences on the date of purchase of the Bellini product by the Consumer and continues for the benefit only of the Consumer until the expiry of three (3) year **(Warranty Period)**.
- 1.6 If within the Warranty Period a manufacturing defect is discovered in the Bellini product or it fails to perform to the Company’s specifications as a result of some defect in materials, components or workmanship (Defect) then the Company will, at its option, repair the Bellini product or supply a replacement Bellini product free of charge. A replacement Bellini product may differ from the original product purchased by the Consumer.
- 1.7 This warranty will not apply to any Bellini product:
- 1.7.1 Installed by any person other than a qualified tradesperson; or
 - 1.7.2 Subjected to misuse, neglect, negligence or accidental damage; or
 - 1.7.3 Operated in any way contrary to any operating or maintenance instructions; or
 - 1.7.4 Improperly handled, installed or maintained; or
 - 1.7.5 Altered or modified prior to or after installation; or
 - 1.7.6 Damaged directly or indirectly by power surges, electrical storm damage or connection to incorrect power supply
 - 1.7.7 Industrial and or Commercial usage is inclusive of staff areas in office/ shop environments, hotel/ motel or other similar accommodation or rental type properties including Bed and Breakfast establishments.

The Australian Consumer Law requires the inclusion of the following statement with this warranty:

Our goods come with guaranteed that cannot be excluded under the Australian Consumer Law. You are entitled to a replacement or refund for a major failure and for compensation for any other reasonably foreseeable loss or damage. You are also entitled to have the goods repaired or replaced if the goods fail to be of acceptable quality and the failure does not amount to a major failure.

**IN ORDER TO MAKE A CLAIM UNDER THIS WARRANTY THE CONSUMER
MUST CALL 1300 373 199 (AUSTRALIA) OR 0800 764 912
(NEW ZEALAND) TO CONNECT TO THE NEAREST AUTHORISED CENTRE**

- 1.8 You must provide proof of your purchase of the Bellini product and the date of purchase in order to obtain the benefit of this warranty.
- 1.9 If you live outside the service area of the Company or one of its service agents, this warranty does not cover the cost of transport of the Bellini product for service nor the service agent's traveling costs to and from your home.
- 1.10 If you are required to transport the Bellini product to the Company or its service agent, you must ensure it is safely disconnected by a qualified tradesman and securely packed and insured. The Company does not accept any responsibility for loss or damage of the Bellini product prior to it being received by the Company or its service agent.
- 1.11 You will be responsible for all costs of returning a Bellini product to the Company and for redelivery of the Bellini product by the Company (whether it is the original or a repaired and/or a replacement Bellini product) and for any other expenses you incur in claiming under this warranty.
- 1.12 The Company or its service agent will examine any Bellini product and if the Company determines that it is defective through no fault of the Owner and is otherwise undamaged, the Company will repair or replace the Bellini product in accordance with this warranty.

DO NOT SEND IN THIS WARRANTY

Fill out the following details and file with your purchase invoice.

RETAIN & FILE WITH YOUR RECEIPT

Your Purchase Receipt/Invoice is proof of date of purchase. If you are unable to establish the date of purchase, or if the fault is not covered by this warranty, or if the product is found to be in working order, you will be required to bear all service call charges.

GSM Retail Australia Pty Ltd reserves the right to discontinue items, modify designs and change specifications without incurring obligation.

Whilst every effort is made to ensure that descriptions, specifications and other information in this publication is correct, no warranty is given in respect thereof and the company shall not be liable for any errors therein.

Purchased from:

Co. Name:

Address:

Date of Purchase:

Serial number:

NOTE: Consistent with our continuing product development policy, improvements may have been made which render the contents of this packaging slightly different to that shown.

**FOR WARRANTY SERVICE CALL 1300 373 199 (AUSTRALIA)
OR 0800 764 912 (NEW ZEALAND) TO CONNECT YOU TO THE NEAREST
AUTHORISED SERVICE CENTRE**

