

Bellini

INSTALLATION & OPERATION INSTRUCTIONS



Bellini 145 Litre Wine Fridge

Model No.

BWF145BI

Fineline: 144281

V3 Sep20

Thank you for purchasing

Bellini Wine Fridge, the appliance carries a 2 year replacement warranty, be sure to retain this Instruction Manual and receipt.

For Technical queries please contact

Aust: 1300 373 199

NZ: 0800 764 912

Content

Safety instructions & warnings.....	1-2
Installation.....	3
Description of the appliance.....	4-5
Operation.....	6-8
Troubleshooting.....	8
Maintenance and cleaning.....	9
Technical parameters.....	10

Safety instructions & warnings

Your safety is of the utmost importance to our company. Please make sure that you read this instruction booklet before attempting to install or use the appliance. If you are unsure of any of the information contained in this booklet, please contact the Consumer Service Support hot line.

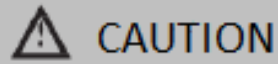
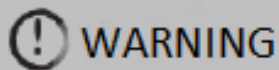
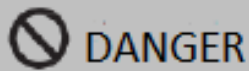

Caution

- This appliance can be used by children aged from 8 years and above and persons with reduced physical, sensory or mental capabilities or lack of experience and knowledge if they have been given supervision or instruction concerning use of the appliance in a safe way and understand the hazards involved. Children shall not play with the appliance. Cleaning and user maintenance shall not be made by children without supervision.
- Children should be supervised to ensure that they do not play with the appliance.
- This appliance is intended for HOUSEHOLD USE ONLY and not for commercial or industrial use.

Warning

- Keep ventilation openings, in the appliance enclosure or in the built-in structure, clear of obstruction.

- Do not use mechanical devices or other means to accelerate the defrosting process, other than those recommended by the manufacturer.
- Do not damage the refrigerant circuit.
- Do not use electrical appliances inside the storage compartments of the appliance, unless they are of the type recommended by the manufacturer.
- Make sure that the appliance is connected to power supply in accordance with the rating label.
- Use an independent grounded socket with 10A or higher, do not connect to transformer or socket with multiple outlets.
- Make sure socket is grounded properly and do not modify power cord & plug.
- Connect power plug with socket firmly in case of possible risk of fire.
- Plug should be within reach for easy disconnection after the appliance positioned in case of accidents occurred.
- Do not store or burn gasoline or other inflammables near the appliance in case of possible fire.

- Do not store inflammables, explosives, acid & alkaline liquids etc. in the compartment of the appliance.
- Do not operate other appliances in the compartment.

Child Safety

- Do not allow child play inside the appliance in case of entrapment.
- Do not allow child hang on the door to play in case of falling of the appliance.
- Do not allow child reach into compressor compartment or touch metal components at rear of the appliance in case of possible injury.

Keep away from water

- Do not spray water on the appliance or wash the appliance by pouring or immersing in water in order to prevent electric shock.

Be careful touching frozen surfaces

- Do not touch internal wall surfaces with wet hands in order to prevent skin adhering and cause injury when appliance is in operation.

Modifications to the appliance are not permitted

- Do not attempt to make modifications to the appliance that may compromise electrical safety or causes damage to the appliance

- Unplug the appliance when not in use
- Unplug appliance when conducting maintenance or cleaning activities on the appliance
- Unplug the appliance in the event of a power shortage

Disposal of the appliance

- Please dispose of the product in accordance with Local council regulations at end of appliance working life.
- Before disposal, remove the door in order to prevent child play accidental trapping inside the appliance that may go unnoticed.
- Dispose of appliance at a designated local council recycling depot



Do not damage the power cord

- Do not disconnect the appliance by pulling on the power cord, only remove from power outlet by holding onto the plug.
- Do not trap the power cord under or between the appliance in situ or transition that may cause damage resulting into electrical safety hazard.
- Keep power cord clear to avoid damage to cord /plug when moving the appliance.

When the power cord is damaged

- Do not use the appliance with a damaged power cord/plug, ensure it immediately gets replaced by service agent or licensed electrician.

Installation

Position



Do not lean the appliance over more than 45° when moving it to position.



The appliance must be placed on flat, firm & dry floor or similar noncombustible pad; do not use the package foam pad.



Do not place the appliance on wet surfaces.



Do not place this appliances in covered areas where its exposed to extreme cold temperatures.



Do not place this appliance outdoors where it is exposed to direct sunlight or weather.

The appliance is designed to either be positioned under benchtop/counter or freestanding.

Illustration for building under the counter:

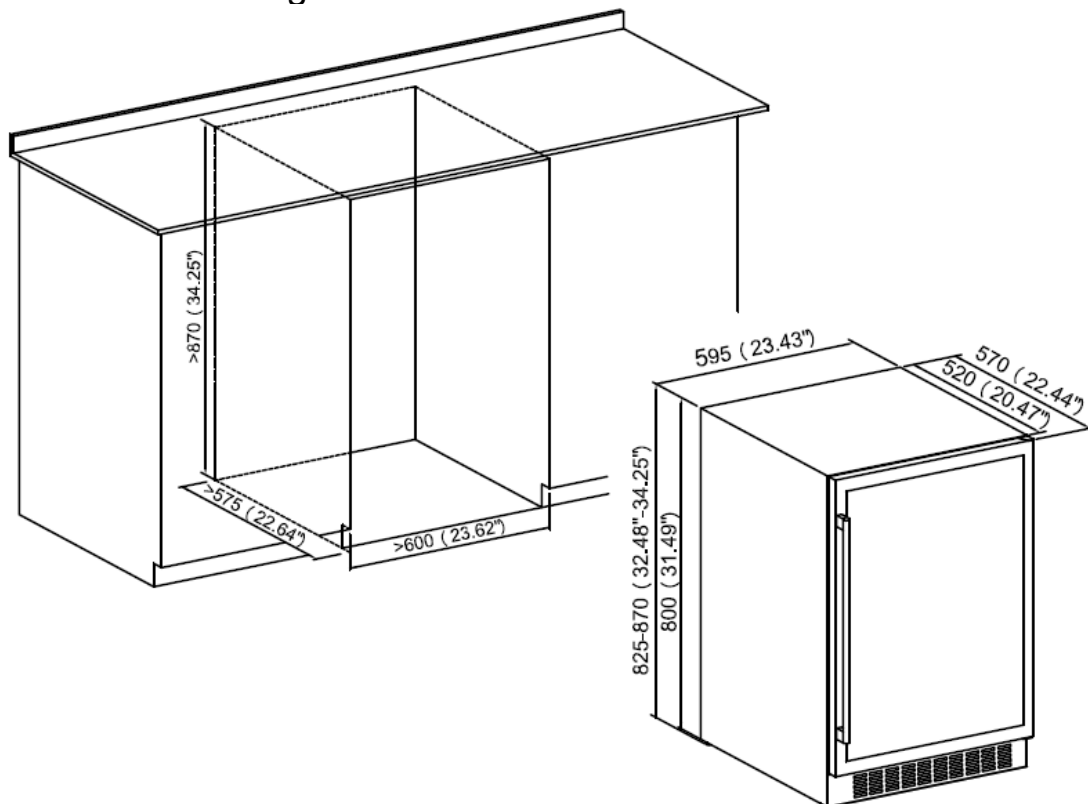

After appliance is first switched On, allow the appliance to cool for a minimum of 1 Hour before placing the wine bottles inside.

Description of the appliance

Accessories & name

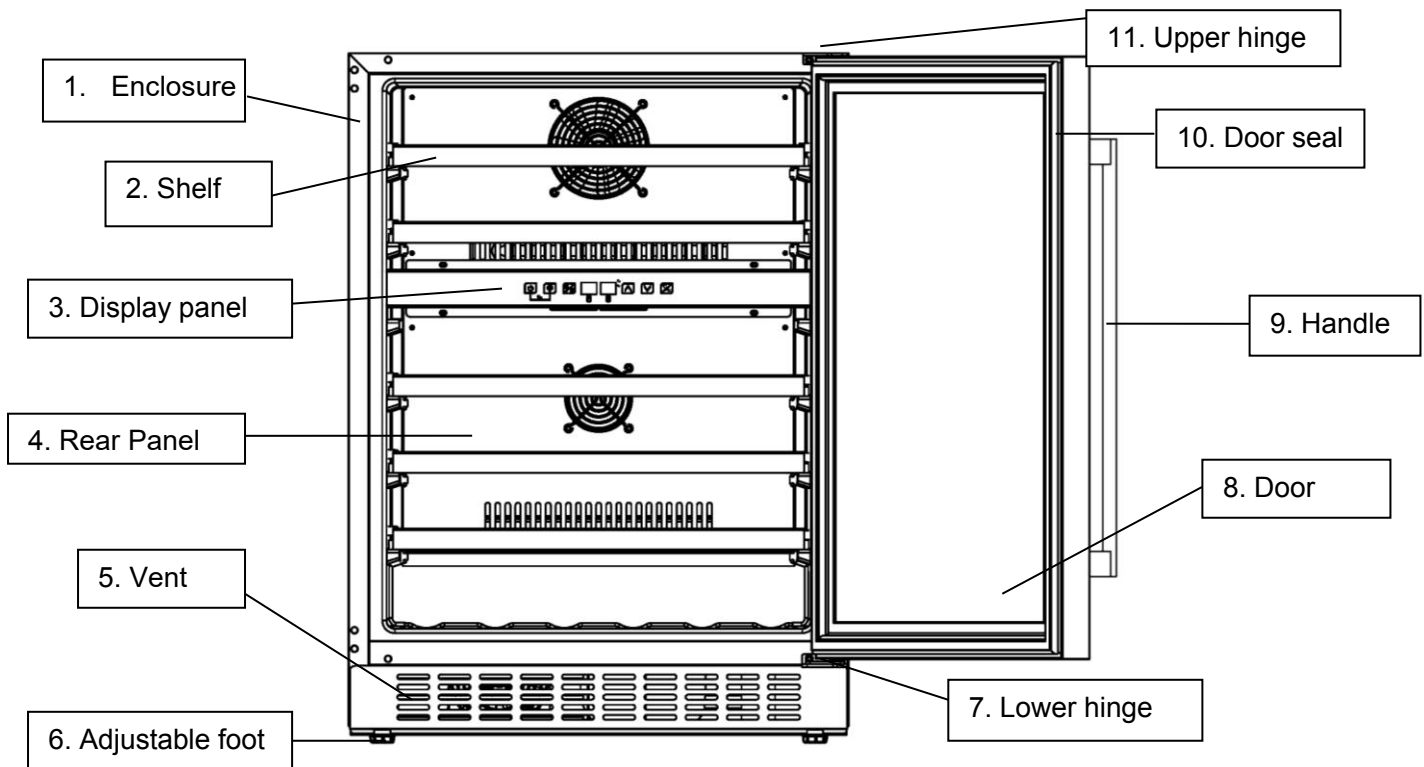

Note: Shelves, door frame, handle and other accessories could be different according to different models and configuration. All photos in this manual are for reference. The appliance you buy might not be exactly the same as shown here. Please refer to the actual product.

Installing the handle and reversing the door of wine cooler

1. Install handle to the door frame of the appliance.

The handle is delivered in a separated package with screws together inside the carton.

- ① Holes for attaching the handle are concealed behind the rubber door seal, pull door seal partially away to gain access and reveal the two small holes on the door frame
- ② Align the screw holes in the door handle with the holes on the door frame, insert screws and secure the door handle by tightening screws with screw driver.
- ③
- ④ Push door seal back into place to conceal the screw heads.

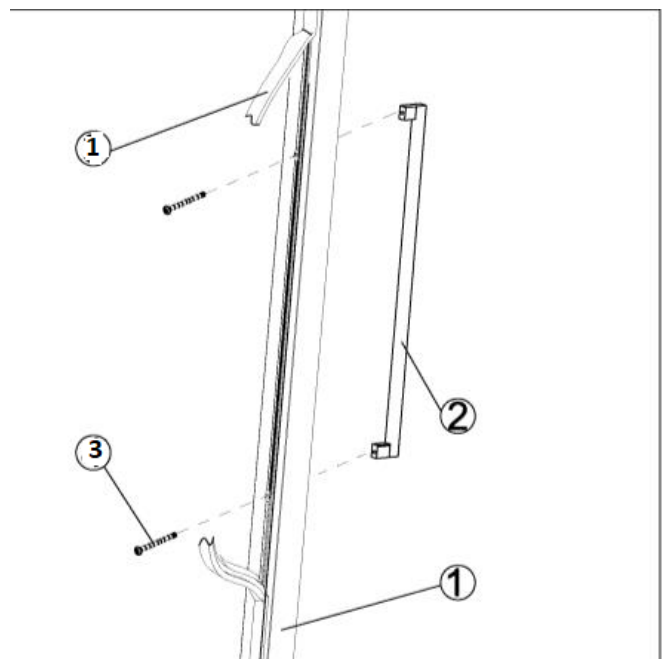

2. Reversing the door

Our wine cooler is delivered with the door opening from left to right. To reverse the opening direction:

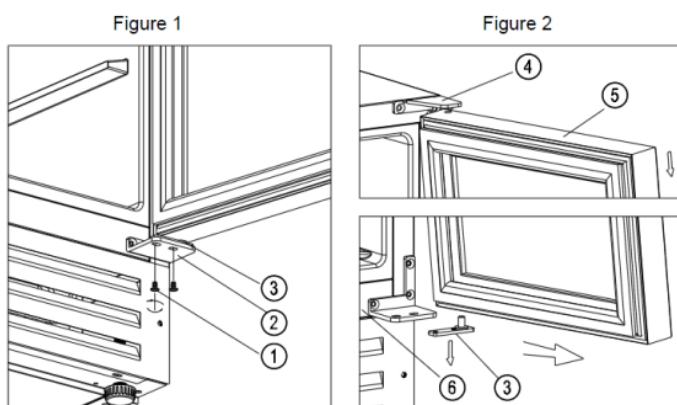

- ✧ Open the door at 90 degrees and keep it steady.
- ✧ Unscrew the two screws ① from the right lower hinge ② [Figure 1].
- ✧ Pull the door ⑤ outwards slowly [follow the arrow direction in Figure 2] to get off the lower hinge ② and continue to pull the door ⑤ downwards slowly to remove the door entirely and away from the top Right hinge ④ now remove lower hinge plate by undoing bracket retaining screws attaching bracket to cabinet [Figure 2].
- ✧ Unscrew top right hand hinge bracket from cabinet, retain both hinge brackets for future use if you want to restore door back to original position. Figure 3]

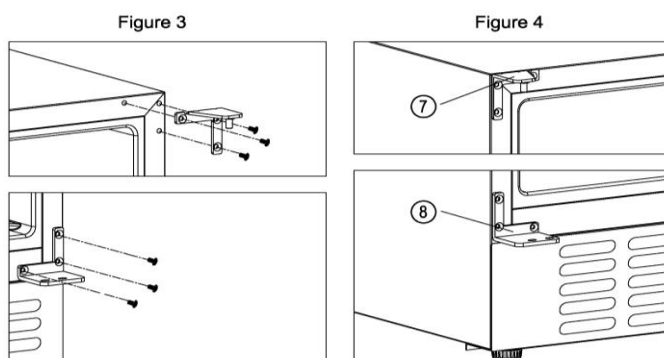

- ✧ Provided with the appliance inside a polybag are the left hand side hinge brackets to suit lefthand door fit, install these hinge brackets in reverse order of removing bracket from the righthand side.[Figure 4]

Turn the door around 180 Degrees so door hinge holes now face the lefthand side, mount the lower hinge plate to the bottom of the door and secure. Lift door into place and interlock top of the door with hinge pin, align bottom of the door holes on cabinet hinge bracket and secure with two screws. Lefthand door fit is now completed.

Operation

Start operation

1. Clean storage compartment

Before switching appliance On, give the storage compartment a clean to remove any dust deposits, at the same time check that drainage pipe is satisfactorily connected . (For details, please refer to the “Maintenance and cleaning”)

2. Let appliance settle after installation

Before switching the appliance On, allow refrigerant to settle first for at least 30 Minutes after installation.

3. Power on

Switch appliance On, allow it to operate for a minimum of 1 Hour and then check that the appliance has actually cooled, if all OK you can now place your wine bottles into the appliance .

Control panel

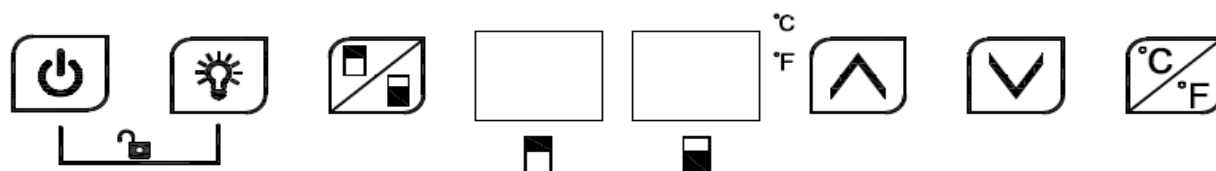

All keys are not active with the appliance in lock mode. Please unlock first.



ON/OFF

1. Press and hold ON/OFF Key for 3 seconds to activate appliance to go in stand-by mode
2. Press ON/OFF key again for 3 seconds to unlock from stand-by mode back to operation mode.



Light

Press light Key to activate or deactivate LED light inside storage compartment. In stand-by mode this operation cannot be actioned.

Zone switch



Press this key to select and switch between Upper and Lower compartment zones to set the desired temperature for the selected zone.

Press key once, the LED Display will flash, indicating that zone is ready to change temperature.

Press arrow UP/DOWN keys to scroll and select the desired temperature, Press zone key again to engage /set the temperature.

Adopt the same process to select and set temperature for the other zone/ compartment.

UP



Press UP Key once , LED display flashes the current set temperature, repeated pressing increases temperature incrementally by 1 Degree, increase until you reach desired temperature, Press Zone Key to set.

Note: Display will flash for 5 Seconds only, if no action is taken during this time or the zone key pressed to lock in new selected temperature, the flashing stops and engages the last set temperature.

Down



Press DOWN Key once , LED display flashes the current set temperature, repeated pressing decreases temperature incrementally by 1 Degree, decrease until you reach desired temperature, Press Zone Key to set.

Note: Display will flash for 5 Seconds only, if no action is taken during this time or the zone key pressed to lock in new selected temperature, the flashing stops and engages the last set temperature.

Child Lock (Combination key)

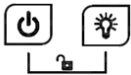

- 1、 Lock: Press both keys at the same time for 3 seconds to lock.
- 2、 Unlock: Press both keys at the same time for 3 seconds to unlock.



Fahrenheit/Celsius display interchange

Switch temperature display between Fahrenheit and Celsius by pressing the key.



Attention

1. For both the upper or lower zones/compartments the temperature can be set to range from 5-22 Degrees, however the lower zone can only be set equal to the upper zone or to a higher temperature (E.g. always set upper zone temperature first for the cooler wines , then lower zone temperature can be increased for higher temperature wines).
2. Alarm sound: when the system separate and alarm sound, press any key on the control panel to cancel the alarm sound.
3. Temperature sensor failure:
When the temperature sensor failures occur, error code displays.
E1 for open circuit and E2 for short circuit of upper zone.
E5 for open circuit and E6 for short circuit of lower zone.

Wine storage

- ✧ The appliance is equipped with sufficient shelf space to allow your collection of wine to mature quietly.
- ✧ 5 shelves loading capacity: **46** bottles. (standard Bordeaux with 750ml)

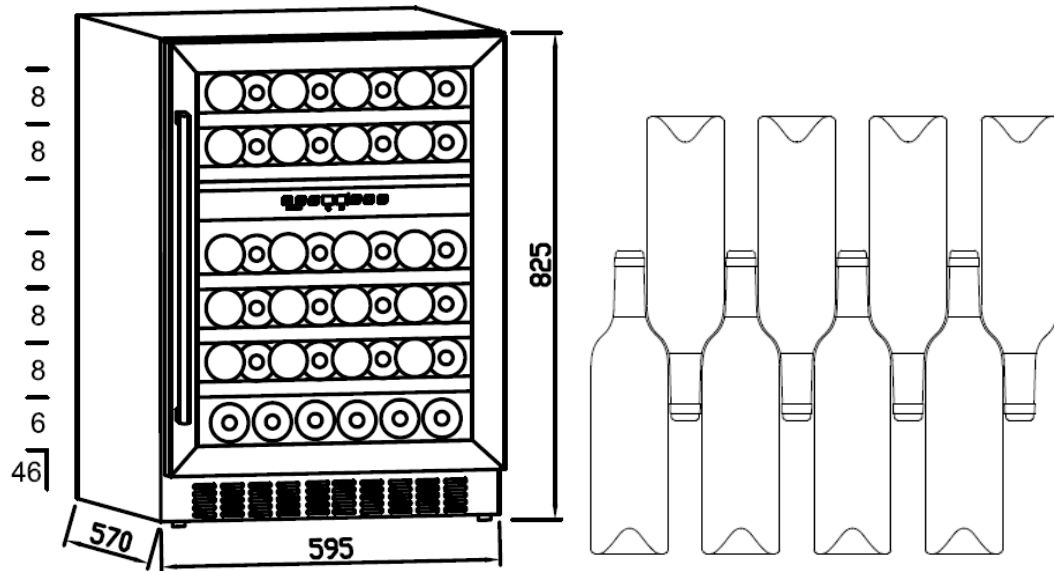

Loading capacity will vary in terms of different way of bottle arrangement or different bottle sizes.

- ✧ Each shelf is designed to put on 1 or 2 layers of wine bottles. More than 2 layers of bottle arrangement on one shelf are not recommended.
- ✧ Open the door fully before pulling out shelves.
- ✧ If the wine cooler would have no load for a long time, it is recommended to power it off, clean it carefully, and open the door for ventilation.
- ✧ Below table is the recommended temperature for wine storing & drinking:

Red Wine	15-18°C
White Wine	9-14°C
Rose wine	10-11°C
Champagne & sparkling wine	5- 8°C

Troubleshooting

The appliance makes lots of noise?	<ul style="list-style-type: none"> ● Please adjust the front foot, keep the appliance level. ● Please keep the appliance a bit space from walls.
Liquid flowing sound inside the cabinet?	<ul style="list-style-type: none"> ● It is normal because of the refrigerant working inside.
The appliance does not start?	<ul style="list-style-type: none"> ● Make sure the appliance is connected to the power properly. ● Make sure switch on the power. ● The compressor re-starts after 5 minutes for a power cut.
Compressor runs continuously?	<ul style="list-style-type: none"> ● If no cold is being produced, call the after-sale service.
Door does not seal tightly?	<ul style="list-style-type: none"> ● After long time use, the door seal might get stiff & distorted partially. <ol style="list-style-type: none"> 1. Heat the door seal with hot-wind blower or hot towel. 2. The door seal get softened and close the door.
The appliance does not cool sufficiently?	<ul style="list-style-type: none"> ● Please adjust temperature setting. ● Keep the appliance away from sunlight or heat. ● Please do not open the door frequently.
Unpleasant smells inside cabinet?	<ul style="list-style-type: none"> ● A little bit plastic smell for newly-buy appliance is normal and will disappear after a short time. ● Clean the compartment and ventilate it for a few hours.
Condensate on the glass door?	<ul style="list-style-type: none"> ● Please do not open the door frequently or for a long time. ● Please do not set the temperature too low. ● High ambient temperature and humidity would cause condensation
The light is not working?	<ul style="list-style-type: none"> ● Check the power supply first. ● Call the retailer's after-sale service if the light is broken.

Maintenance and cleaning

Cleaning

- Disconnect the appliance before cleaning.
- Clean the appliance with soft cloth or sponge by water.
- Do not use organic solvents, alkaline detergent, boiling water, washing powder or acid liquid etc.
- Do not flush the compartment of the appliance.

The below items will damage the surface of wine cooler:

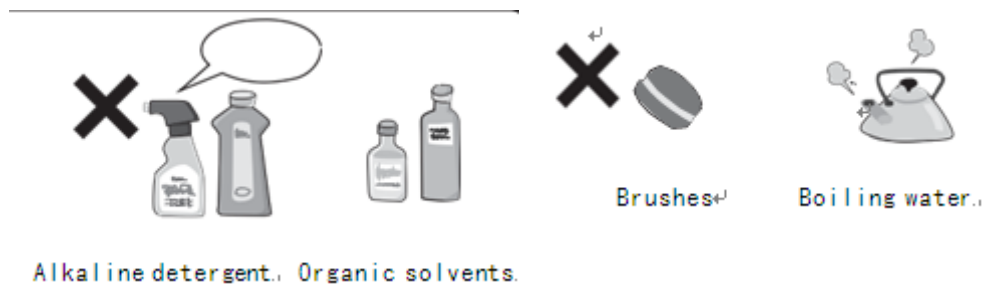

Power cut

Most power cuts could be resolved within a short time. To protect your wines during a power cut, avoid opening the door as much as possible. During very long power cuts, take the necessary measures to protect your wine.

Out of service for long time

Remove all bottles from the appliance, unplug the appliance, thoroughly clean the inside and outside of the appliance, store the appliance properly.



If the appliance is disconnected or if there is a power cut, you must wait at least five minutes before re-starting.

Moving the appliance

- Cut off the power supply and unplug the appliance.
- Remove all bottles from the appliance.
- When moving the appliance, do not lean the appliance over 45°.

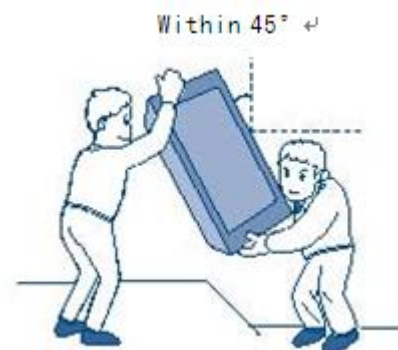

Technical parameters

Product model	BWF145BI
Voltage/frequency	220-240V~/50Hz
Refrigerant/weight	R600a/35g
Gross volume	145 L
Loading capacity	46 bottles
Net weight	44.5kg
Unit dimension (WxDxH)	595×570×825-870mm
Packing dimension (WxDxH)	680×670×900mm

Remarks :

1. The Net weight includes shelves and the Unit dimension is without handle on the door.
2. The manufacturer reserves all the rights to change the above parameters without prior notice. Please refer to the nameplate of your appliance.
3. Loading capacity will vary in terms of different way of bottle arrangement or different bottle sizes (standard Bordeaux with 750ml is applied here).
4. The product height could be adjusted from 825 to 870mm by 4 plastic feet.

WARRANTY

- 1.1 In this warranty:
- 1.1.1 Australian Consumer Law means the law as set out in Schedule 2 of the Competition and Consumer Act 2010;
 - 1.1.2 **Company** means GSM Retail Australia Pty Ltd ABN 53 007 682 475 of 142-144 Fullarton Road, Rose Park SA 5067. Telephone 1300 373 199. Email admin@gsmretailaust.com.au;
 - 1.1.3 **Consumer** means a “consumer” as that term is defined in Section 3 of the Australian Consumer Law as the original purchaser of a Bellini product;
 - 1.1.4 **Consumer Guarantees** means the guarantees under the Australian Consumer Law;
 - 1.1.5 **You** means the Consumer.
- 1.2 Nothing in this warranty affects any person’s rights under the Australian Consumer Law. The benefits to any Consumer under this warranty are in addition to the rights and remedies available under any Consumer Guarantees.
- 1.3 Subject to the other clauses of this warranty, the Company warrants to the Consumer that the Bellini product will be free of manufacturing defects and will perform to the Company’s specifications.
- 1.4 The benefit of this warranty extends only to the Consumer as original purchaser of a Bellini product, which is installed in a domestic household area.
*The in Home warranty does not apply to Commercial and or industrial usage. *Please see 1.7.7 for additional information
- 1.5 This warranty commences on the date of purchase of the Bellini product by the Consumer and continues for the benefit only of the Consumer until the expiry of two (2) year **(Warranty Period)**.
- 1.6 If within the Warranty Period a manufacturing defect is discovered in the Bellini product or it fails to perform to the Company’s specifications as a result of some defect in materials, components or workmanship (Defect) then the Company will, at its option, repair the Bellini product or supply a replacement Bellini product free of charge. A replacement Bellini product may differ from the original product purchased by the Consumer.
- 1.7 This warranty will not apply to any Bellini product:
- 1.7.1 Installed by any person other than a qualified tradesperson; or
 - 1.7.2 Subjected to misuse, neglect, negligence or accidental damage; or
 - 1.7.3 Operated in any way contrary to any operating or maintenance instructions; or
 - 1.7.4 Improperly handled, installed or maintained; or
 - 1.7.5 Altered or modified prior to or after installation; or
- 1.7.6 Damaged directly or indirectly by power surges, electrical storm damage or connection to incorrect power supply
- 1.7.7 Industrial and or Commercial usage is inclusive of staff areas in office/ shop environments, hotel/ motel or other similar accommodation or rental type properties including Bed and Breakfast establishments.

The Australian Consumer Law requires the inclusion of the following statement
with this warranty:

Our goods come with guaranteed that cannot be excluded under the Australian Consumer Law. You are entitled to a replacement or refund for a major failure and for compensation for any other reasonably foreseeable loss or damage. You are also entitled to have the goods repaired or replaced if the goods fail to be of acceptable quality and the failure does not amount to a major failure.

**IN ORDER TO MAKE A CLAIM UNDER THIS WARRANTY THE CONSUMER
MUST CALL 1300 373 199 (AUSTRALIA) OR 0800 764 912
(NEW ZEALAND) TO CONNECT TO THE NEAREST AUTHORISED
CENTRE**

- 1.8 You must provide proof of your purchase of the Bellini product and the date of purchase in order to obtain the benefit of this warranty.
- 1.9 If you live outside the service area of the Company or one of its service agents, this warranty does not cover the cost of transport of the Bellini product for service nor the service agent's traveling costs to and from your home.
- 1.10 If you are required to transport the Bellini product to the Company or its service agent, you must ensure it is safely disconnected by a qualified tradesman and securely packed and insured. The Company does not accept any responsibility for loss or damage of the Bellini product prior to it being received by the Company or its service agent.
- 1.11 You will be responsible for all costs of returning a Bellini product to the Company and for redelivery of the Bellini product by the Company (whether it is the original or a repaired and/or a replacement Bellini product) and for any other expenses you incur in claiming under this warranty.
- 1.12 The Company or its service agent will examine any Bellini product and if the Company determines that it is defective through no fault of the Owner and is otherwise undamaged, the Company will repair or replace the Bellini product in accordance with this warranty.

DO NOT SEND IN THIS WARRANTY

Fill out the following details and file with your purchase invoice.

RETAIN & FILE WITH YOUR RECEIPT

Your Purchase Receipt/Invoice is proof of date of purchase. If you are unable to establish the date of purchase, if the fault is not covered by this warranty, or if the product is found to be in working order, you will be required to bear all service call charges.

GSM Retail Australia Pty Ltd reserves the right to discontinue items, modify designs and change specifications without incurring obligation.

Whilst every effort is made to ensure that descriptions, specifications and other information in this publication is correct, no warranty is given in respect thereof and the company shall not be liable for any errors therein.

Purchased from:

Co. Name:

Address:

Date of Purchase:

Serial number:

NOTE: Consistent with our continuing product development policy, improvements may have been made which render the contents of this packaging slightly different to that shown.

**FOR WARRANTY SERVICE CALL 1300 373 199 (AUSTRALIA) OR
0800 764 912 (NEW ZEALAND) TO CONNECT YOU TO THE NEAREST
AUTHORISED SERVICE CENTRE**

